

THERMA-KLEEN

Operators Manual

Therma-Steam® Model XL3



Made in the USA

THERMA-KLEEN
2415 E. Huron PO Box 805
Au Gres, MI 48703
Ph: 630-718-0212 Fax: 989-876-6640
E-mail: sales@therma-kleen.com
Web Site: www.therma-kleen.com

January 15, 2019



Therma-Steam® Model XL3

OWNERS MANUAL

Do Not Use This System Without Reading This Manual First

You should be familiar with the information in this manual before you operate your equipment. The manual is structured so that it can be used for your reference.

<u>Page</u>	<u>Description</u>
3	SERVICE INFORMATION
4	MACHINE SPECIFICATIONS
5	WHAT IS VAPOR STEAM CLEANING
5	SAFETY INFORMATION
9	GROUNDING
8	OPERATING INSTRUCTIONS
10	CONTROL PANEL
11	STEAM CONTROL VALVE
11	RESERVOIR TANK
12	LOW WATER ALARM
12	BOILER
12	DRAIN
12	HOSE MAINTENANCE
13	COOLING FAN
13	GUN TRIGGER
13	MAINTENANCE
14	STAINLESS STEEL BODY
14	FILTER
14	ELECTRICAL REQUIREMENTS
14	OPERATING TEMPERATURES
15	ACCESSORIES
20	PARTS LIST
22	WARRANTY

All information, illustrations and specifications contained within this manual are based on the information available at the time of production.

THERMA-KLEEN®, reserves the right to make changes at any time.



Therma-Steem® Model XL3

SERVICE INFORMATION:

Therma-Steem® Model XL-3

Please take the time to fill out the form on this page. When completed, this reference form will provide information essential to the proper servicing and ordering of parts for your THERMA-STEEM® Industrial 400 Model.

OWNER:

Name of Business: _____

Address: _____

City, _____ State: _____ Zip Code: _____

Telephone: _____ E-mail: _____

Serial #: _____ Date Shipped: _____

Our sales and parts department will be glad to answer any questions or provide troubleshooting help over the phone. All parts will be shipped via UPS unless otherwise specified. The warranty card must be filled out on our Web Site to activate your warranty.

www.THERMA-KLEEN.com

Address: Therma-Kleen, Inc.

P.O. Box 805, 2415 E. Huron Rd. Au Gres, MI 48703

Telephone: 630-718-0212 Fax: 989-876-6640

E-Mail: sales@therma-kleen.com

MACHINE SPECIFICATIONS:

Water pressure:	155 psi
Maximum water temperature of this unit:	365°F
Size:	23"W x 33" L x 30" H handle from the floor: 34 ½",
Weight:	260 lbs.
Electrical Requirements:	480V, 3 ph, 60-amp outlet *If you are in need of another voltage, please contact our sales department.
Amp Draw:	480 volt: 49 amps
Heating Element:	40 kw
Boiler Size:	5 gallons
Reservoir tank:	7 gallons
Wheels 5":	locking wheels
Wheels 10":	Semi-pneumatic wheels

Standard Unit includes:

25 ft. Stainless Steel Hose with Trigger Gun
 Curved Nozzle Attachment
 Blast Nozzle Attachment
3 ft. Extension
20" Extension
Triangle Brush
2 ½" Nylon Brush
2 ½" Brass Brush
2 ½" Stainless Steel Brush
3 each -1" Nylon, Brass and Stainless-Steel Brushes
Gloves
Goggles
2- Towels
Microfiber Cloth
Funnel

WHAT IS VAPOR STEAM CLEANING:

Vapor Steam Cleaning is a unique way of cleaning. Understanding how vapor cleaning works will enable you to clean more effectively. The dry vapor, in the form of gas, penetrates into the surface pores and violently expands, forcing dirt and debris to the surface where the particulate is either suspended in a re-condensed water molecule or driven into an absorbent cloth. The dry vapor is super-heated and is hot enough to kill bacteria and sanitize all surfaces. Vapor cleaning does not rely on pressure in order to clean efficiently. Once the vapor is emitted from the tool head, physics take over and the vapor works on its own. Therefore, only enough vapors are required to fill the pores under the tool head and it is not necessary nor desirable to operate the equipment at full volume. More effective cleaning results are achieved by turning the volume down and let the vapor and heat do the cleaning. If the equipment is operated at too high of a volume, the unit will not maintain pressure for extended periods of time, it will use too much water and oversaturated the surface that you are cleaning.

SAFETY:

READ ALL INSTRUCTIONS BEFORE USING THE VAPOR CLEANING SYSTEM. Under no circumstances shall Therma-Kleen or its agents be held responsible for any injury or damage to people or property that may be caused by failure to follow the instructions below or by improper use of the equipment.



WARNING:

Your Therma-Steam unit is designed to be an entirely safe if used properly and incorporates the latest and most state-of-the art safety features.

Paying Close Attention to your system and surroundings are necessary when your Vapor Steam System is being used.

TO REDUC THE RISK OF ELECTRICAL SHOCK, FIRE OR PERSONAL INJURY, FOLLOW ALL THE INSTRUCTIONS AND ALWAYS USE BASIC PRECAUTIONS, INCLUDING THE FOLLOWING:

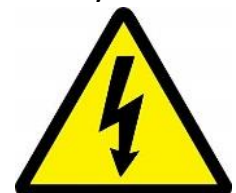

- 1 **ALWAYS** - Check the machine, power & steam hose for damage prior to start-up. If damage is detected, it must be repaired prior to use.
- 2 **CAUTION** - Before use check the electrical cord for damage, wear & tare, cuts or abrasion.
 - a. **DO NOT** - use your machine with a damaged electrical cord.
- 3 **NEVER** - Plug the unit into an un-grounded electrical receptacle.
- 4 **CAUTION** - The Electrical Outlet must be a GFI (Ground Fault Interrupt). If you are unsure the receptacle is grounded, contact a certified electrician.
 - a. **CAUTION** - If the Power Outlet is damaged, have a certified electrician repair the outlet.
 - b. **NEVER** - Touch the electrical plug or unplug the unit with wet hands or while standing in a wet environment.
 - c. **NEVER** - Allow the electrical power cord to lie in water while cleaning.
 - d. **NEVER** - Unplug from the receptacle by pulling on the cord, always grasp the plug itself Make sure the unit is unplugged.
- 5 **NEVER** - Touch the system with wet hands or while standing in a wet environment.
- 6 **NEVER** - Allow the machine to get wet as electrical shock may occur.
- 7 **CAUTION** - Use extra caution when using the system around water (Swimming Pools, Spas, Toilets, Etc.)
- 8 **DO NOT** - allow the electrical power cord or Steam Hose to be run over, stepped on or have something placed or dropped on it.
- 9 **DO NOT** - allow the Electrical Power Cord or Steam Hose to be caught in a closed door or pull over a sharp corner.
- 10 **CAUTION** - Turn off all controls prior to unplugging the unit.
- 11 **ALWAYS** - wear long sleeves, long pants, eye goggles, and gloves while operating your cleaner.
- 12 **CAUTION** - Make sure all attachments are secured before activating the gun.
 - a. **CAUTION** - Only operate the unit when it is in a Horizontal position.
- 13 **WARNING** - To prevent scalding or burning, ALWAYS keep your hands and body away from the nozzle tip during operation and wear appropriate protective clothing.
 - a. **DO NOT** - touch the steam nozzle while in use, or until after it cools.



Fig. 2

- b. **DO NOT** - grab the hot steam hose without appropriate gloves.
- 14 **NEVER** - Point or direct the wand or steam at any person, animal or electrical outlet or anything which could be damaged.
- 15 **DO NOT** - move or lift the machine by pulling on the electrical cord.
- 16 **DO NOT** - move or lift the machine by pulling on the steam hose or gun.
- 17 **DO NOT** - bend the steam hose past the 2" bend radius. This will shorten the life of your hose.
- 18 **DO NOT** - use you Vapor Steam Cleaner if it has been dropped or damaged.
- 19 **DO NOT** - allow the Vapor Steam System to become wet.
- 20 **DO NOT** - operate without water, this will damage the cleaner's heating element, low water sensor and/ or pump.
- 21 **DO NOT** - fill the water reservoir under a water tap. Always use a funnel and pour from a measured container so as not to over fill the reservoir. Consult the machine specifications to determine the reservoir capacity.
- 22 **NEVER UN-SCREW** - the boiler fill cap or drain plug while water is still hot or there is pressure in the unit as this may result in a dangerous release of steam or water which can cause a scalding hazard.
- a. By activating the trigger on the gun will help dissipate pressure in the boiler
- 23 **CAUTION** - Hand tighten the boiler fill cap.
- a. **DO NOT** - over tighten as this will lead to premature failure of the sealing gasket.
- 24 **DO NOT** - run chemicals through system, this could be harmful to people and the cleaner.
- 25 **CAUTION** - Use caution when working in confined spaces, as the steam could cause debris to kick back towards you and the steam may seem greater.
- 26 **DO NOT** - use this unit to clean items that may be harmed by steam or linger too long on surfaces that may cause damage.

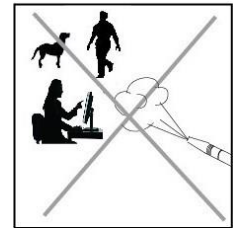

- 27 **DO NOT** - leave this unit unsupervised when in use or while cooling.
- 28 **DO NOT** - allow children to use or handle machinery.
- 29 **CAUTION** - Replace worn or damaged power cords, gaskets and “O”-rings.
- 30 **DO NOT** - try to repair your machine, contact an Authorized Service Company or the factory. Retain your box for shipping.
- 31 **DO NOT** - allow objects to get into the output nozzle. Do not try to operate the Vapor Cleaning System with any of the openings blocked. Keep openings free of dust, lint, hair, or anything which may reduce the flow of Vapor
- 32 **CAUTION** - Always keep all parts of the body away from the output nozzle, moving parts.
- 33 **CAUTION** - Extra care must be taken when using the unit on stairways.
- 34 **CAUTION** - Never use the Vapor Cleaner to clean animals.
- 35 **CAUTION** - If the “Air Vent Cap” becomes damaged or is lost, **DO NOT** replace with any other cap as it is not a pressure cap. Please reference the service part section of this manual and contact Therma-Kleen® for a replacement.
- 36 **ALWAYS** - Turn off unit when not in use – and allow to cool before storing.
- 37 **ALWAYS** - Unplug the Vapor System Electrical Cord when the system is not in use.
- 38 **ALWAYS** - Completely empty all water from the unit when not being used.
- 39 **NEVER** - Transport the unit with any water remaining in the machine.
- 40 **NEVER** - Leave the unit outside or allow it to be exposed to Freezing Temperatures.
- a. Freezing will severely damage the unit, internal components and hose.



WARNING:

Your Therma-Kleen Vapor Steam Cleaner MUST BE PLUGGED INTO A GROUNDED OUTLET, or electrical shock can occur. Check with a certified electrician if there is any doubt that the outlet is grounded. Do not modify the Power Cord/Plug provided with the Therma-Kleen Vapor System. If it will not fit the outlet, have a properly grounded outlet installed by a certified electrician.



NOTE:

The 25 ft. length of the input power cord should not normally be increased. If additional length is required, consult the national & local electrical codes and ordinances as well as seeking the advice of a qualified electrical engineer before proceeding.

WHY THIS UNIT MUST BE GROUNDED:

If the unit should malfunction or break down, grounding provides a path of least resistance for the electrical current to pass, reducing the risk of electrical shock. All Therma-Kleen units are equipped with a power cord with an equipment grounding conductor. (Plugs are not normally supplied for higher voltage machines). An appropriate plug must be inserted into an appropriate outlet which is properly grounded in accordance with national & local electrical codes and ordinances.

Therma-Kleen Model XL3 are designed for use with a normal 208/240, 480, 575 volt 3-phase grounded circuit.

OPERATING INSTRUCTIONS:

Note: See Machine control panel for power requirements for your particular model prior to operating this machine. Always wear gloves, goggles, and long sleeves and pants.

1. Make sure that all switches are in the OFF position and the machine is unplugged.
2. Remove water reservoir vent cap, which is located on top of the machine. Please do not substitute cap.
3. Using the funnel provided, with clean water (preferably distilled water), begin to fill into the reservoir, taking care not to overfill (approx. 7 gals. empty).
4. Insert the 4 prong, 3 phase power cord plug end into an appropriate electrical socket. Plug end to be supplied by the customer.
5. Then turn the MAIN POWER switch to the "ON" position. The green light will then activate.

6. If the boiler requires water, the pump will activate, indicated by the blue light and a “vibrating-type” sound. The boiler will fill with approx. 4 gals of water. It will take approximately 30 minutes to fill the boiler when the boiler is empty.
7. After this sound ends and the blue light goes out, indicating the pump has stopped, it is now safe for you to activate the HEATER switch. **IMPORTANT: NEVER** turn on the HEATER switch until the pump has stopped, indicating the boiler is full.
8. Temperature reading is indicated by temperature gauge on panel. Temperature is set by factory. **DO NOT** reset temperature.
9. You may now top off the reservoir (at opening) with water, if desired, replacing the reservoir vent cap.
10. When the boiler is at maximum temperature (about 365° F), the amber HEATER light will cycle ON and OFF, indicating highest temperature. It will take approximately 15 minutes to reach maximum temperature.
11. Then, adjust the flow of steam with the steam control knob situated on the side of the machine.
12. When the ADD WATER white light illuminates, the reservoir is empty. You may elect to remove the reservoir vent cap and refill with water and resume cleaning.
13. When the blinking red light is activated, this indicates low water in the boiler, the alarm will sound, and the heater is de-activated. To re-activate the heater, fill the reservoir. The pump will then fill the boiler from the reservoir. When the boiler has cooled sufficiently (approx. 340°F), the reset button (located under the red indicator light) can then be pushed, which will then re-activate the heater. An empty boiler takes approx. 30 minutes to fill.
14. **SHUT DOWN INSTRUCTIONS:** Turn HEATER and MAIN power switches to “OFF” positions and release steam from boiler by depressing trigger on gun. Close the steam control knob on the side of the machine. Unscrew the steam hose before storing on brackets. Unplug machine when storing or not in use.

CONTROL PANEL:

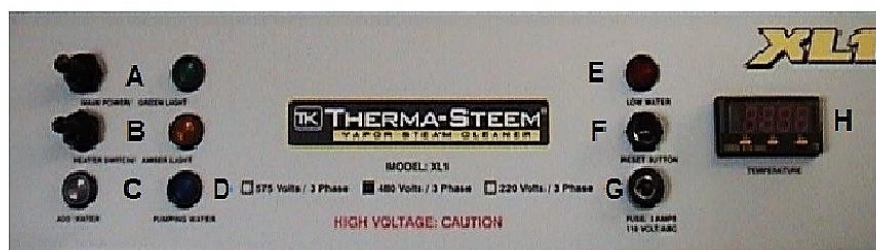

January 15, 2019

- A.) On/Off switch (left) for Main Power with green indicator light (right).
- B.) On/Off switch (left) for heater with amber indicator light (right).
- C.) Add Water white indicator light.
- D.) Blue indicator light comes on when the boiler is being filled.
- E.) Low water (red blinking) indicator light.
- F.) Reset button for low water alarm.
- G.) Fuse holder with ABC 3-amp fuse.
- H.) Temperature Control.
- I.) Water Reservoir vent cap (on top of machine, not shown).
- J.) Operating Instructions (on the top of machine, not shown).

STEAM CONTROL KNOB:

This knob is located on the side of the machine and controls the volume of steam. Turn counter-clockwise increase, clock-wise decreases. For maximum pressure and temperature, leave the knob turned to the highest pressure setting. Always close when you are finished cleaning and/or when you want to remove the hose.



RESERVOIR TANK:

The reservoir tank with your unit holds approx. seven (7) gallons of water. The reservoir is designed to contain the water supply which is fed to the boiler and additional water as the boiler calls for it. When you engage the MAIN power switch, if the boiler requires water the pump will then turn "ON". DO NOT turn on the heater to the boiler before the pump stops pumping, indicating that the boiler is full. The blue light indicates that the boiler is calling for more water and water is pumping to the boiler. The reservoir has a reservoir vent cap, which covers the fill opening; this can be removed to add more water at any time. This cap is an air vent fitting. DO NOT substitute or replace with a garden hose fitting. Do not run the pump dry. **DO NOT** fill the reservoir with a garden hose.



LOW WATER ALARM:

When the reservoir is out of water and the boiler is almost empty, a low water alarm will sound, and the red light will flash to let you know that the heater has shut off and you are out of water. If you elect to refill, you may do so, but the heater will not reactivate until the temperature reads approx. 340°F, at which time you may press the reset button on the control panel to reactivate the heater and resume prior working temperatures of 365°F. This sensor protects your heating element.

BOILER:

DISTILLED WATER”

We only recommend that you use distilled water. This would eliminate the possibility of creating hard-water stains while you are cleaning and prevent excessive build-up of mineral deposits in the boiler. If you are using tap water, remember that the life of the heating element may be shortened due to mineral/scale build-up. The heating element and/or the boiler will not be covered under warranty if this situation happens.

CHEMICALS:

VERY IMPORTANT: NEVER INTRODUCE CHEMICALS INTO THE SYSTEM.

It may void your warranty and may result in malfunction and/or damage to your system.

DRAIN:

Your machine has two drains. One is for the reservoir and the other one is for the boiler. The boiler drain plug is located underneath and toward the back (by the handle end) of the machine. The reservoir drain plug is the other. A flathead screwdriver may be used to remove plugs. This will release the water. Use caution since the water in the boiler may remain hot for a significant period of time. Replace plugs carefully.

HOSE MAINTENANCE:

This unit is supplied with a high temperature, all stainless-steel hose. It is very important to protect the quality of this hose by not exceeding the bend radius of 2”. If a hose is subjected to excessive wear and tear, it will not be covered under warranty. Please inspect your hose and cover on a regular basis for any wear. Always

STAINLESS STEEL BODY:

The housing and handle on your THERMA-STEEM® XL3 are made of stainless steel. We recommend that you preserve the finish by keeping the machine dry and polished. Use a good stainless-steel cleaner, being careful not to remove any instructions.

FILTER CONNECTED TO THE PUMP:

The filter connected to the pump (see below) needs to be checked on a regular basis. Even if distilled or filtered water is being used in this machine, the filter may still get clogged with mineral sediment. To check the filter, look for discoloration and/or detach from the pump line and see if you are able to blow air through it, if it is discolored or little or no air goes through, the filter should be replaced. When reinstalling make sure it is installed the same way and direction as it was originally installed.

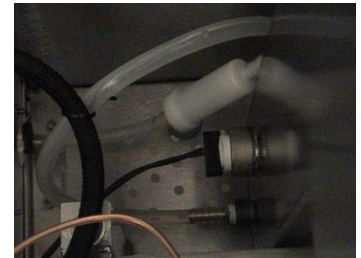

ELECTRICAL REQUIREMENTS:

Check your serial plate on the back of your machine to determine the voltage. This machine is available in 480, 3-ph, 49 Amps.

480-volt models:

This unit draws 49 amps. Replace with 50 amp fast acting fuse. See inside panel for style.



If you need to replace a fuse on the control panel:

- 1.) Turn all the switches to the "OFF" position to cut the power to the machine.
- 2.) Unplug your machine from the power outlet.
- 3.) Push down and twist on the fuse cap to release the cap and fuse.
- 4.) Pull the fuse from the cap and replace with an ABC fast acting 3-amp fuse.
- 5.) Place the fuse and cap back in the fuse holder and push down while twisting. This will lock the cap into place. Make sure it is locked.
- 6.) Plug the machine into an electrical outlet.

OPERATING TEMPERATURES:

The maximum temperature in the boiler is 365°F. This is controlled by a DIN digital controller, which is located on the control panel of the machine. The temperature control is set at the factory; this should not be altered in any way. At this temperature, your unit will achieve its highest pressure of 155 PSI. The temperature on this model will be controlled with this component to maintain a constant temperature and pressure as it is being used

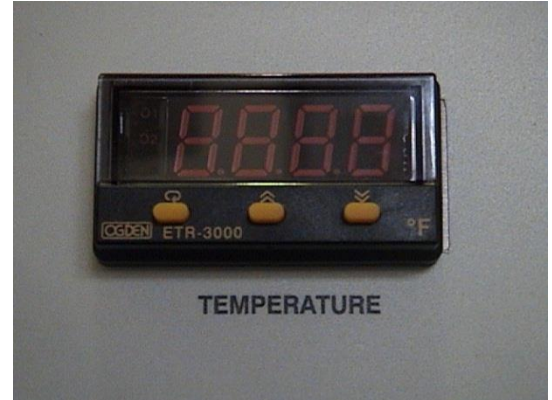

ACCESSORIE DESCRIPTION:

All attachable accessories for the Model XL1 use threaded ends due to the higher pressures.

Each of the accessories and attachments are recommended of the following specific cleaning tasks:

Triangle Brush:



The Triangle Brush may be used for diverse applications on many surfaces. It can be used on almost any dry surface type including (but on limited to), Fabric, All Metals, Ceramic, Stone, Porcelain, Vinyl, Leather and Plastic.

Generally, use of the triangle brush is dictated by the size of the object or surface being cleaned, rather than a specific surface type. The Triangle Brush is used when the surface is too large to be cleaned with the Detail Tool or too small to be cleaned by the Wide Brush. The Triangle Brush can also be used on large areas that are too dirty for the Wide Brush to work effectively.



Use of a Cloth: The Triangle Brush can be used with or without a cloth. If a cloth is to be used, there are clips on the brush to attach the cloth. When used without a cloth on

a hard surface, the surface will need to be wiped with a clean, dry cloth immediately after passing over the surface with the Triangle Brush.

Rough Textured surfaces: It is more desirable to clean without a cloth or mitten over the brush.

Fabrics: A cloth is or is not necessary when cleaning fabrics. Placing a cloth over the brush is not necessary when the desired goal is to sanitize the fabric more than to clean it. To remove certain carpet stains, place a terry cloth or microfiber cloth on the stain and gently apply the brush to the stain. The stain will incrementally be driven into the cloth. Gradually move the cloth to absorb the stain into the clean areas of the cloth, until the stain is gone.

Most of the time, better results will be achieved by placing a terry or microfiber cloth over the Triangle Brush. This is done by placing the cloth on a smooth surface and neatly folding the cloth over the brush. Push down on the clips (located on top of the brush) and tuck the cloth underneath. Release the clips and the cloth will be securely fastened to the brush. When covered with an absorbent cloth, cleaning becomes a one-step process. Simply wipe the surface slowly and all dirt and debris will be driven into the cloth, hard surfaces will usually dry in less than a minute.

WIDE BRUSH:

The 12" Wide Brush is used to clean larger areas. The Wide Brush is faster than a mop and certainly does a more effective job. The Wide Brush is generally used more for daily or weekly cleaning & sanitization rather than restoration.

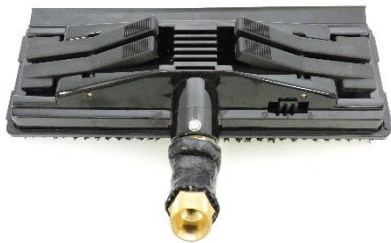

MATERIALS – Fabrics, Metals, Ceramic, Stone, Porcelain, Vinyl, Leather, Plastic, Wooden Floors, Waxed Floors – Carpet (200 degrees or less for Nylon carpets),

Upholstered Chairs, Draperies, Etc. or any other surface that extreme heat does not harm the surface which you intend to clean.

USE – the size of the area more than the type of surface dictates the use of the Wide Brush.



CLOTH – Use of a Cloth: The Triangle Brush can be used with or without a cloth. If a cloth is to be used, there are clips on the brush to attach the cloth. When used without a cloth over it, on a hard surface, the surface will need to

be wiped with a clean, dry cloth or mop immediately after passing over the surface.

When cleaning a rough textured surface, it is more desirable to clean without a cloth over the brush. Fabric surface – same as Triangle Brush.

VAPOR VOLUME – adjust the volume to about 3/8. Occasionally more volume will be required, however volume should always be less than 1/2. If the volume is turned too high the surface will become oversaturated, requiring more time to dry, also it will become difficult for the unit to maintain pressure for extended periods of time

SQUEEGEE:



The Squeegee can be used on Glass, Windows, Countertops and other smooth surfaces. As with the other tools, the Squeegee will both clean & sanitize.

Glass Cleaning – Adjust the volume to 1/4 or less. Start at the top of the window in one corner and pull down to the bottom of the glass & repeat until the entire surface has been cleaned. Turn off & squeegee dry & wipe the bottom of the pane or sill with a clean dry cloth. Excessive vapor volume will result in too much water on the glass, simply turn down the vapor volume.

Smooth Surfaces – Adjust the volume to 1/4 or less. Start on one corner and slowly proceed from one side the other. Wipe with a clean dry cloth when excessive water becomes present.



DETAIL & BLAST TOOLS:

Use – to clean small areas that are difficult or impossible to clean using any other method. You will be able to clean areas which are too small to clean with a tooth brush. Example – Faucets, Fixtures, Dishwasher Edges, Stains in Carpets, Car Interiors, Deodorize, Etc.

The detail tool should almost always be used with the detail brush attached to the end of the detail tool. has an Exceptions to this are when cleaning condensers, radiators, artificial plants and real plants which are sprayed with a cool vapor from a distance is the preferred method of cleaning.

Because of the increased pressure of the Model 400, the detail tool has a threaded end.

Operate this tool at 1/4 volume. For best results first gently rub the surface with the end of the tool, heating it. Make a second pass, after the surface is heated and dirt & debris will be completely removed. Once clean wipe the surface with a dry absorbent cloth.

Clean hard to reach areas and corners first, then proceed with the appropriate larger brush.

NYLON DETAIL BRUSH

1" Dia.

2-1/2" Dia.



Use - to be used where there is a possibility of scratching the surface, such as Bath Tubs, Door Jambs, Grout, Glass Shower Doors (Pre-steam) Etc. When in doubt about which brush to use, the Nylon brush first. This brush can generally be used on almost any surface except on flat

latex wall paint and non-water proof ceiling tiles.

STAINLESS STEEL DETAIL BRUSH:

1" Dia.

2-1/2" Dia.



Use - Stainless Steel is hard and should only be used on surfaces that are scratch resistant. Always test in a small area before proceeding. This brush can be used on surfaces such as masonry, certain tiles such as Quarry tile and high-quality stainless steel. This brush

can be used to remove some painted areas if the surface will undergo a sanding process prior to repainting. If in doubt test an out of the way area first. The stainless-steel brush will also leave a black mark, which is difficult to remove on certain types of tile.

BRASS DETAIL BRUSH:

1" Dia.

2-1/2" Dia.



Use - This brush can be used on many metal surfaces as well as on some Tile, Ovens, Etc. Always test on an out of the way area before to Use. Brass is softer than stainless steel and will consequently wear faster.

This brush works well on oxidized aluminum surfaces, it will however, have a polishing effect and make the surface look brighter than areas which have not been cleaned with this tool.

BRASS DETAIL BRUSH:

1" Dia. 2-1/2" Dia.



Use - This brush can be used on many metal surfaces as well as on some Tile, Ovens, Etc. Always test on an out of the way area before to Use. Brass is softer than stainless steel and will consequently wear faster. This brush works well on oxidized aluminum surfaces, it will however, have a polishing effect and make the surface look brighter than arras which have not been cleaned with this tool.

HORSE HAIR DETAIL BRUSH: Optional

1" Dia. 2-1/2" Dia.

Use - Most commonly used on material which is delicate and has fine details. The Natural Horse Hair is naturally soft, durable and nonabrasive, and packed with thousands of genuine horse hairs which tend to wrap around a surface and because they are fine, they tend to penetrate deeper than other brush materials. They are perfect for delicate jobs such as leather, vinyl, cloth, porcelain, scratch sensitive plastic, Jewelry, Automotive Detaining as it works well by gently cleaning all Interior surfaces, air vents, convertible tops, etc. They are generally considered safe on all surfaces, but it is best to test on an inconspicuous area before beginning.

TRIGGER GUN:

A safety feature on your machine is a Steam Hose Trigger Gun with a Trigger Lock. Whenever the system is powered up and you set the steam gun/wand down it is very important that you engage the trigger lock to avoid accidental steam discharge. Also, whenever you change attachments, it is very important you place the guns trigger in the locked position towards the handle.

To Lock the Trigger simply slide the red lever, located on the trigger, toward the handle

Unlocked Position

Locked Position



WAND EXTENSIONS:

One 18" & One 36" insulated wand extensions, which attach to the end of the Vapor Steam hose. These extensions allow the operator to easily reach places which otherwise would be difficult to clean.

PARTS LIST:

Gun
 3/8" 25 ft. hose w/gun
 24" mx Pulse Hose
 Hose Cover

Part# 4034-A
 Part# 5096
 Part# 3712
 Part# 4059



Triangle Brush



3 ft. Extension
 Part# 5016

Zero Degree Blast
 Nozzle Part# 5103
 Curved Nozzle
 Attachment Part#
 5102
 20" Extension
 Part# 5008
 Part# 5009

Sm. Microfiber Cloth	Part# 3534
Floor Brush (optional)	Part# 5011
Lg. Microfiber Cloth	Part# 3910
2 ½" Brass Brush	Part# 4008
2 1/2" Nylon Brush	Part# 4009
2 ½" Stainless Brush	Part# 4102
1" Nylon Brush	Part# 4010
1" Brass Brush	Part# 4011
1" Stainless Brush	Part# 4012
¼" European Plug	Part# 4071
¼" Male Swivel Fitting	Part# 4070
¼" Female Swivel Fitting	Part# 4069
3 Amp, 110v Fuse	Part# 5002
50 Amp,3 Phase Fuse	Part# 5012
Pump and motor	Part# 5097
Repair Kit "A" for pump	Part# 5098
Repair Kit "B" for pump	Part# 5099
Repair Kit "C" for pump	Part# 5100
Pressure Relief Valve	Part# 5101
DIN Temp Control	Part# 5001
Limit Controller	Part# 5000
Solid State Relay	Part# 5004
5" Brake Wheel	Part# 5003
Goggles	Part# 4053
Gloves	Part# 4052
Funnel	Part# 3499

XL3 PUMP BREAKDOWN:

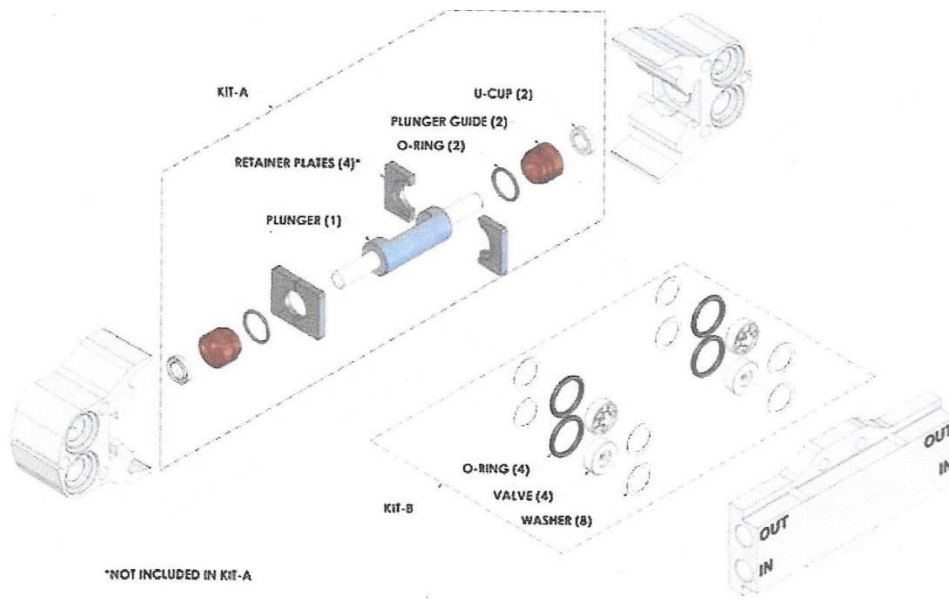

For your convenience, we have included a breakdown of the XL3 pump. This pump can be repaired with the parts listed on the previous page.

Limited Warranty

THERMA-KLEEN®, Inc. as manufacturer, warrants to the original purchaser, each new machine for a period of one year from date of shipment from the factory, to be free from defects in material and workmanship under normal use and service. “Normal use and service” means not in excess of recommended maximum pressures, temperatures, incorrect fuels, or handling fluids not compatible with component materials, as noted in THERMA-KLEEN®, Inc. manuals. This warranty shall not apply to any machine or component which has been repaired or altered to adversely affect the performance or reliability of this product. The heating element on the THERMA-STEEM® models will not be covered if distilled water is not used or scale is present. The boiler has a lifetime warranty.

Neither this warranty nor any implied warranty applies to damage or harm caused by any or all of the following:

- 1.) Freight damage;
- 2.) Freezing damage;



Therma-Steem® Model XL3

- 3.) Damage caused by parts and/or accessories or components not obtained from or approved by THERMA-KLEEN®, Inc.;
- 4.) Any consequential or incidental damages arising from the use of a THERMA-KLEEN®;
- 5.) Damage due to misapplication or misuse. Pump valves and bearings on the Ultra models are not warranted if they are broken.

The liability of THERMA-KLEEN® under the forgoing warranty is limited to repair or replacement of a defective component or part at THERMA-KLEEN®'s option. The defective component will be returned to the original manufacturer for judgment as to whether the component failed under normal operating conditions and therefore replaced or misused. These parts must be returned to the regional office or manufacturing facility within the warranty period, at the sole expense of the purchaser. This warranty is limited to furnishing of the parts for replacement exclusive of installation labor. The liability of THERMA-KLEEN®, Inc. under any theory of recovery (except any express warranty where the remedy is set forth in the above paragraph) for loss, harm or damage, shall be limited to the lesser of the actual loss, harm, damage, or the purchase price of the involved machine.

THERMA-KLEEN®, Inc. expressly warrants its machines as above stated. There are no other express warranties. Any implied warranties, including warranty of merchantability or of fitness for a particular purpose or merchantability when this product is put to an industrial, commercial or rental use. Before using any product, customer shall determine the suitability of the product to comply with all local and state regulations for its intended purpose and the customer assumes all risk and liability whatsoever in connection therewith.

No person including any dealer or representative of THERMA-KLEEN®, Inc. is authorized to make any representation or warranty concerning THERMA-KLEEN®, Inc. products on behalf of THERMA-KLEEN®, Inc. or to assume for THERMA-KLEEN®, Inc. the obligations contained in this warranty. THERMA-KLEEN®, Inc. reserves the right to make changes in design and other changes and improvements upon its products without imposing any obligations upon itself to install the same, upon its existing products or products then in process or manufacture.